

HP-250

Major League Home Plate with Spikes

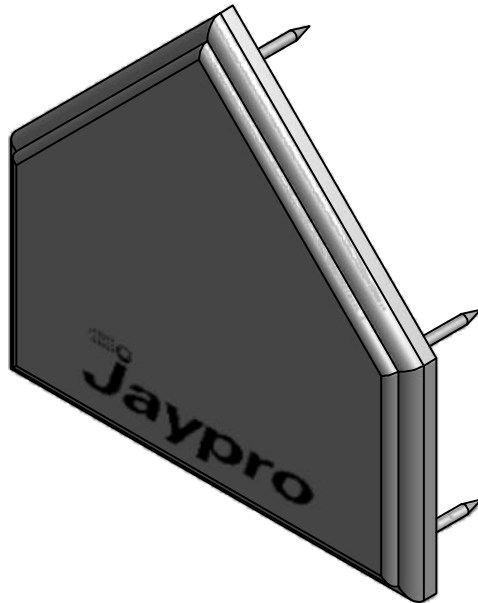

- High durability, molded rubber construction
- Stanchion mounted steel plate
- Easily removed for maintenance or storage
- Comes with sleeve or removable 5 zinc-plated spikes

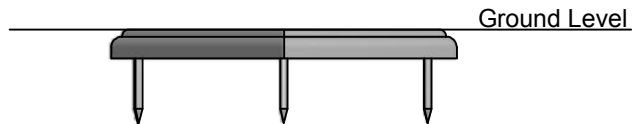

NOTE: When installing do not pound directly on the plate because it may cause damage. Place a 2 inch thick piece of wood over the plate and use a hammer to lightly pound on the block of wood.

CAUTION

Installer should make sure top of home plate is level with playing surface.

REV.	DESCRIPTION	DATE	BY	www.jaypro.com		DRAWING NAME / PART NUMBER:	
						HP-250	
						DRAWN BY:	ISSUE DATE:
				FAX: 860.444.1779 (SALES) 860.440.0628 (ENG.)		DC	6/12/2006
						PHONE: 800.243.0533 (TOLL FREE) 860.447.3001 (LOCAL)	
COPYRIGHT 2006 JAYPRO SPORTS, LLC. ALL RIGHTS RESERVED				THIS PRINT IS THE PROPERTY OF JAYPRO SPORTS, LLC. AND MAY NOT BE REPRODUCED WITHOUT WRITTEN PERMISSION		BTS	
HP-250 Major League Home Plate with Spikes						JAYPRO SPORTS, LLC, 976 HARTFORD TURNPIKE, WATERFORD, CT 06385 USA	SHEET:
						1 OF 1	A